

2019

MCA EXCELLENCE AWARDS

Brought to you by our Premier Sponsors:
RDO Equipment Company
Montana811.org



MONTANA CONTRACTORS ASSN.
Quality People. Quality Projects.

Advanced equipment. Smarter solutions. RDO does that.



At RDO Equipment Co., we provide customized solutions to help you work smarter and maximize profit. Our team pairs world-class John Deere equipment with the latest technology, like SmartGrade™, so you can take your business to the next level.

Call your local RDO Equipment Co. to see how we can help.

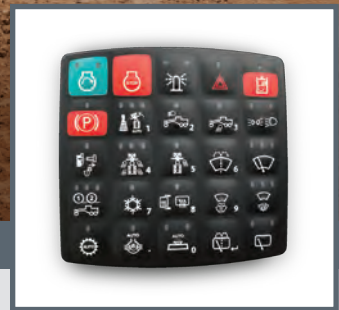

MONTANA

Billings	406-259-5536
Bozeman	406-551-2141
Great Falls	406-452-8521
Kalispell	406-752-2828
Missoula	406-549-4171



RDOequipment.com

2019 MCA EXCELLENCE AWARDS

Message from the Executive Director:

During the course of my first year as your Executive Director, I made it a mission of mine to get out in the field and personally meet as many members face-to-face as my schedule would allow. With a state as large as ours, it becomes a challenge to get to everyone, so if I haven't made a visit with you yet, please be patient – I'm on my way soon!

As my travels took me to all four corners of our great state, I couldn't help but notice the excitement of growth in our local communities. This excitement is shown through the tremendous projects that are being accomplished daily by our members. The pride you take in your craft and the distinct quality of the projects you build is clearly evident.

I would like to extend a heartfelt congratulations to our Excellence Awards winners, and thank all of our applicants for presenting us with their quality work. And thank you to all MCA members for your dedication to our industry, and our association. On behalf of the Board and staff, I wish you all the best in 2020!

David Smith
DAVID SMITH, EXECUTIVE DIRECTOR

Judges:
DAVE FRENTRESS, CalPortland
DON CLEM, NRMCA Northwest Region
ALASKA CHAPTER of the AGC

MCA Staff:
DAVID SMITH
KEITH OUZTS
NICOLE HANNI
BARRY HOUSER



MONTANA CONTRACTORS ASSN.
Quality People. Quality Projects.

1717 11th Avenue
Helena, MT 59601
(406) 442-4162 | www.mtagc.org

AWARD WINNERS

Highway - Best Reconstruction of Urban/City Project.....Page 3
Project: Zimmerman Trail Intersection Improvement, Billings
General Contractor: RIVERSIDE CONTRACTING

Concrete - Technical Merit.....Page 3
Project: Boeing Interior Mass Machine Pads, Helena
General Contractor: DICK ANDERSON CONSTRUCTION

Concrete - Industrial/Commercial \$1-5 Million.....Page 3
Project: Eagle Jet Hangar, Great Falls
General Contractor: SLETTEN CONSTRUCTION

Environmental - Special Recognition - Water Quality.....Page 3
Project: Bullhook Storm Water Cleanup, Havre
General Contractor: LAKESIDE EXCAVATION

Building - Best Commercial Project.....Page 4
Project: Northwest Pipe Fittings Inc., Billings
General Contractor: DICK ANDERSON CONSTRUCTION

Concrete - Paving.....Page 4
Project: Baxter-Love Roundabout, Bozeman
General Contractor: A.M. WELLES

Building - Best Institutional Project.....Page 4
Project: Montana Children's, Kalispell
General Contractor: SWANK ENTERPRISES

Concrete - Water/Sewer/Utilities.....Page 4
Project: City/County Drain CM/GC Mitigation, Billings
General Contractor: COP CONSTRUCTION

Education Foundation - Contractors in the Community.....Page 4
Project: Digger Days, Belgrade
General Contractor: TMC, Inc.
SIME CONSTRUCTION
KNIFE RIVER

Environmental - Special Recognition/Habitat Restoration.....Page 5
Project: Dry Creek Fish Bypass, Belgrade
General Contractor: ALLIED ENGINEERING SERVICES

Building - Best Industrial Project.....Page 5
Project: Laurel Water Treatment Plant Phase 3
General Contractor: COP CONSTRUCTION

Building - Best Historic Restoration.....Page 5
Project: Story Mill Community Park, Bozeman
General Contractor: LANGLAS & ASSOCIATES

Concrete - Industrial/Commercial >\$5 Million.....Page 5
& 2019 Judge's Award
Project: Yellowstone International Airport Parking Garage,
Bozeman
General Contractor: SLETTEN CONSTRUCTION

Building - Best Custom Residence.....Page 5
Project: Fellows Residence, Clinton
General Contractor: DICK ANDERSON CONSTRUCTION

2019 Highway Excellence Awards - "Best Reconstruction of Urban/City Project"

RIVERSIDE CONTRACTING

Zimmerman Trail Intersection Improvement, Billings

The Zimmerman Trail Project was a reconstruction of the existing Zimmerman Trail roadway which winds up the face of the rimrocks in Billings to provide access between west Billings and MT-3 / Airport Road. The project including widening the roadway to two 12-foot lanes and 4-foot shoulders where feasible; storm drain improvements; construction of an MSE wall with additional slope stabilization including micro piles, rock/soil nails, and wire mesh; and the addition of concrete gutters and substantial barricades on the downslope side. On the north end, a roundabout was constructed to allow safer and more efficient access onto Highway 3. In addition, improvements made in Zimmerman Park included a paved walking trail and a pedestrian tunnel under Zimmerman Trail to allow safe pedestrian passage under the road.



2019 Concrete Excellence Awards - "Technical Merit"

GENERAL CONTRACTOR: DICK ANDERSON CONSTRUCTION

CONCRETE SUPPLIER: HELENA SAND & GRAVEL

Boeing Interior Mass Machine Pads, Helena

This project consisted of the installation of a 1100 CY mass concrete foundation required to support industrial equipment used by Boeing in the manufacturing of critical tolerance aeronautic parts. The project specifications required the concrete design to be non-air entrained, at a maximum w/c ratio of 0.44 with a 28-day compressive strength of 4500 psi. With the incorporation of fly ash in the mix design, the contractor was able to accomplish the large mass placement and limit the heat generation from the cement hydration. During the curing process, temperatures were monitored to ensure internal mass and near surface temperature differences did not exceed 30 degrees. Adjustments to the placement of concrete blankets helped control the temperatures during the curing process within acceptable tolerances helping avoid thermal cracking issues.



2019 Concrete Excellence Awards - "Industrial/Commercial \$1-5 Million"

GENERAL CONTRACTOR: SLETTEN CONSTRUCTION

CONCRETE SUPPLIER: UNITED MATERIAL OF GREAT FALLS

Eagle Jet Hangar, Great Falls

The 200-by-200 foot hangar was constructed for private jet aircraft while they are parked at the Great Falls Airport. The interior slab on grade was constructed to support the large aircraft parking in the hangar. The eight-inch-thick interior slab included #5 rebar placed at 12 inches on center each way. The interior slab also included in-floor heat tubing. It was imperative to the owner that the floor slab be placed in one monolithic pour to avoid having construction joints in the hangar floor. After two pre-pour construction meetings, it was decided to place the concrete at night to avoid high temperatures and winds. The reduced traffic during the night also allowed for consistent on time delivery throughout the pour. Two testing companies were used to ensure the concrete slump was in the specified range for the project throughout the pour.



2019 Environmental Excellence Awards - "Special Recognition - Water Quality"

LAKESIDE EXCAVATION

Bullhook Storm Water Cleanup, Havre

In 2016 the city of Havre advertised for bids on the Bullhook Stormwater Improvement project, a project that replaced the main stormwater conveyance through Havre. An out-of-state contractor was the low responsive bidder. In turn, they entered into a contract with the City of Havre and proceeded with the project. After struggling with the execution of the project, they pulled off. The City of Havre then went back to Lakeside Excavation, a bidder on the original project with the capabilities and knowledge to finish the project. Lakeside excelled in the tight quarters of this project, setting a 20,000-pound box culvert that is 10 feet wide in an easement no wider than 20 feet, with existing utilities both below ground and overhead. After completing this work, there were no more open holes in the streets and right of ways. Neighborhoods started to return to normal after up to 6 years of open holes in the streets.



2019 Building Excellence Awards - "Best Commercial Project"
DICK ANDERSON CONSTRUCTION

Northwest Pipe Fittings Inc., Billings

This new building sits on 12 acres in west Billings and totals 105,246 square feet. The new facility design incorporates all facets of Northwest Pipe's operations; including administrative offices, customer training areas, City Desk for walk-in traffic, The Water Closet for product display, high piled storage in the warehouse and service area. There is approximately 16,500 SF that makes up the retail and office spaces. The office spaces are built on an access floor, which serves as an underfloor plenum for the heating and cooling system. The warehouse, which makes up the remaining 72,000 SF will house NWP's inventory on its high piled storage system. The 8" warehouse slab has approximately 15 miles of pex tubing for in-floor heat. The exterior lot consists of a 10-acre paved storage yard, loading dock that can accommodate 6 trucks, and a parking area for employees and customers.



2019 Concrete Excellence Awards - "Paving"

GENERAL CONTRACTOR: A.M. WELLES
CONCRETE PRODUCER: KNIFE RIVER
CONCRETE CONTRACTOR: TREASURE STATE, INC.

Baxter-Love Roundabout, Bozeman

The Baxter Lane/Love Lane Roundabout is the first ever completed in the State of Montana with a slip-form paver. Just under 1,050 cubic yards of concrete was placed within the project. The majority of the non-colored PCCP was slip-formed. All the variable height curb and gutter and median cap on top of the asphalt was slip-formed. All 592 square yards of colored mountable curb and truck apron were slip-formed monolithically AND stamped with a random flagstone pattern in just a portion of a workday. The concrete scope was topped off with colored median cap. The 2907 Ton, 4" thick asphalt paving from the 4-legged PCCP intersection outward to the road tie-ins was self-performed.



2019 Building Excellence Awards - "Best Institutional Project"

SWANK ENTERPRISES

Montana Children's, Kalispell

Montana Children's was created to provide local access to high quality pediatric specialty care, and to reduce the need for Montana families to travel to out-of-state hospitals. The 190,000 square foot facility, designed exclusively for children, is the only one of its kind in the State of Montana. The project site was recovered from the former loading and storage area of the hospital campus. The project features extensive custom curtainwall glazing, aluminum composite panels, and limestone-clad aluminum exterior panels, as well as terrazzo in the reception desk and grand stair. Full scale test models were used in the design.

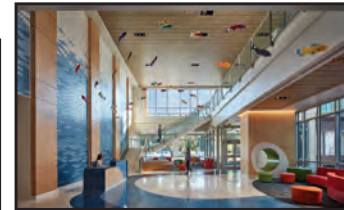

2019 Concrete Excellence Awards - "Water/Sewer/Utilities"

GENERAL CONTRACTOR: COP CONSTRUCTION
CONCRETE SUPPLIER: FISHER SAND & GRAVEL
PRECAST PRODUCER: FISHER SAND & GRAVEL

City/County Drain CM/GC Mitigation, Billings

The project included the installation of approximately 4,400 linear feet of 48" pipe and four large concrete structures throughout the Yellowstone River and the existing City/County Drain channel. The main structure is the housing for a large weir gate which was installed to allow water to flow from the City's storm drain system out to the river. It also provides a level of protection against the river backwater flowing into the drain. The gate system was supplied with water level sensors, gate actuators, motors, and control equipment to continuously monitor the water levels of the City County Drain. With the project's intention of cutting off water flow into the city from the Yellowstone River it was required that a fish by-pass be installed since the City County Drain is a spawning ground for minnows.



2019 MCA Education Foundation - "Contractors in the Community Award"

GENERAL CONTRACTORS: TMC, INC.; SIME CONSTRUCTION, KNIFE RIVER

Digger Days, Belgrade

Digger Days is a one day event that allows children of all ages to explore the world of construction. This event began in 2011 to help raise money for Eagle Mount and to help promote the construction industry as well as provide an opportunity for work force development. Numerous companies come together to make this all happen with the primary sponsors being TMC Inc, Sime Construction, and Knife River. This event makes our youth of today see construction as a fun, exciting industry to join. It opens their eyes to all the opportunities that are available for them in their futures, whether it is laying concrete, building bridges, or driving/operating equipment. This is a wonderful venue that gives the opportunity for work force development which has become a concern in this field. It also serves as a fundraiser for Eagle Mount, an organization that serves individuals with disabilities of all ages and children with cancer.



2019 Environmental Excellence Awards - "Special Recognition - Habitat Restoration/Enhancement"

ALLIED ENGINEERING SERVICES

Dry Creek Fish Bypass, Belgrade

This project has created beneficial impacts to a large population of trout, as well as maintaining the critical irrigation canal that farmers in the area rely on. The underground bypass concept was a creative design solution to a long standing issue in the Gallatin Valley. Multiple groups with overall conflicting interests were able to come together to find a solution that met everyone's needs. The project is fairly complicated, as the bypass channel had to have the capacity to handle an unregulated stream susceptible to runoff. The bypass then has to drop four feet of elevation (by using step pools) so that the stream can be diverted under the existing irrigation canal so that the canal and irrigation water it conveys was not disturbed. Finally, the bypass has to be able to be closed off during the winter and spring runoff months - thus the headgate across the Creek needs to be removable so that during runoff, debris and ice don't build up causing flooding.



2019 Building Excellence Awards - "Best Industrial Project"

COP CONSTRUCTION

Laurel Water Treatment Plant Phase 3

The Phase 3 Laurel Water Treatment Plant project design was to demo the existing covered sediment basins and construct a new building with advanced water treatment to better meet the City's water demand. The new building is more efficient at removing sediments from the water. This is accomplished by mixing flocculant into the water as it enters the building then routing the water through flocculation and sedimentation basins. All the work COP Construction LLC completed had to be performed while maintaining water to the City's filters so the plant could continue to supply water to The City of Laurel and the CHS Refinery.



2019 Building Excellence Awards - "Best Historic Restoration"

LANGLAS & ASSOCIATES

Story Mill Community Park, Bozeman

The Story Mill Community Park embraces the natural and cultural features embedded in the site while introducing active and passive recreational opportunities for Bozeman's outdoor-oriented community. Story Mill, a 19th century flour milling complex, is one of the city's most iconic and historically significant landmarks. The namesake park's design celebrates this rich history through materiality, views, repurposed trail alignments, and educational interpretation. The park transforms a former mobile home park, grounds from a historical slaughter house, and adjacent vacant lands into a destination for Bozeman. The restored beauty of the site features the confluence of Bozeman Creek and the East Gallatin River, restored wetlands, views of the Bridger Mountain Range, and is home to wildlife such as deer, wild turkey, over 100 bird species, and even a black bear was resident on the property during construction.



2019 Concrete Excellence Awards - "Industrial/Commercial >\$5 Million"

& "Judge's Award"

GENERAL CONTRACTOR: SLETTEN CONSTRUCTION

CONCRETE SUPPLIER: KNIFE RIVER

PRECAST PRODUCER: PRECAST BY DESIGN

Yellowstone International Airport Parking Garage, Bozeman

The general scope of work for this project was Division-3 Concrete work. There were 18.5K cubic yards of concrete poured into the building, and this concrete work alone cost more than half of the overall project budget. Once the structure was poured, metal panels were hung around the entire building exterior for both aesthetics and security. The front side had two-tone perforated metal panels as cladding, and the backside was covered in chainlink fence panels for security. In addition to the concrete garage structure, a connecting building was constructed to serve as a corridor between the existing terminal and the new garage.



2019 Building Excellence Awards - "Best Custom Residence"

DICK ANDERSON CONTRUCTION

Fellows Residence, Clinton

The Fellows residence, consisting of 15,475 square feet is organized along a central circulation spine parallel to Rock Creek. The main living functions are arranged in an open plan where family members can be in a variety of functional spaces yet maintain visual connectivity. The house contains 4 fireplaces, 6 bedrooms, 9 bathrooms, 2 kitchens, and 2 laundry rooms, and along with all the custom finishes, the 21 month construction schedule was met. Exterior spaces were incorporated into the design, including a copper hot tub, fire pit and pizza oven along with a tree house and shed. Landscaping transitions from organized and detailed planting beds and lawn to native grasses



5 complete this custom residence.

2020

One-Call Excavator and Utility Training



Excavator Training: (Meal Included)

- MT Dept of Labor and Industry - Underground Facilities Protection Program (DLI-UFPP) Incident Statistics.
- Incident Report UFPAC Reviews
- Ticket Submission Requirements
- Safe Excavation Practices
- Case Studies

Locate Marks - Documenting and Maintaining.

- Best practices for documenting and maintaining locate and white-lining marks.
- Taking good pictures prior to and during excavation to improve your damage documentation

Classes start January 22nd

**For more information and to register go to:
www.montana811.org**

**Know what's below.
Tap, Click, or Call
811 Before you dig.**



See you next year!

Helena, MT
January 27-29, 2021



MONTANA CONTRACTORS ASSN.
Quality People. Quality Projects.

1717 11th Avenue • Helena, MT 59601
(406) 442-4162 • www.mtagc.org